

TO: SWALE JOINT TRANSPORTATION BOARD
DATE: 17th March 2008
SUBJECT: Proposed No Waiting At Any Time Parking Restrictions
London Road, Sittingbourne
BY: Divisional Manager Mid Kent
Classification: Unrestricted

Summary: A report on the proposal to introduce No Waiting At Any Time between 126 – 140 London Road, Sittingbourne
Decision Required: For information

Introduction

1. The developers (Wickes Stores) have been granted planning permission to develop the vacant site adjacent to Cryalls Lane. As part of that planning permission the developers are proposing to introduce traffic management measures (annexe A) to allow safer and easier access to their new development.

Discussion

2. The proposed Waiting Restrictions was advertised on the 10th February 2008 and the residents affected by the proposal were sent a consultation letter and plan of the scheme. The consultation period ended on the 29th February.
3. Numerous objections have been received complaining that the unrestricted parking they have enjoyed outside their property will be lost and they will be forced to park elsewhere. Also residents in adjacent roads are concerned that the displaced cars will clog up their road. A petition has also been raised by the owners of the convenience store at number 144.
4. The proposed waiting restriction will effectively result in the loss of 6 parking spaces between numbers 126 to 144 as four of these properties have dropped kerbs providing access to off street parking.
5. London Road forms part of the A2 which is an important strategic road running through Sittingbourne. Similar parking restrictions have been applied along this road to safeguard junctions and turning facilities and maintain the free flow of traffic.

Decision Required

6. Members are asked that no further action is taken in respect of the objections as previous consultation during the planning process did not receive any adverse representation against the proposed new access. The objectors are notified accordingly.

Contact Officer:
Stephen Huckle 01622 798350
Stephen.huckle@kent.gov.uk

Background documents:
Annexe A – No Waiting restrictions

Annexe A

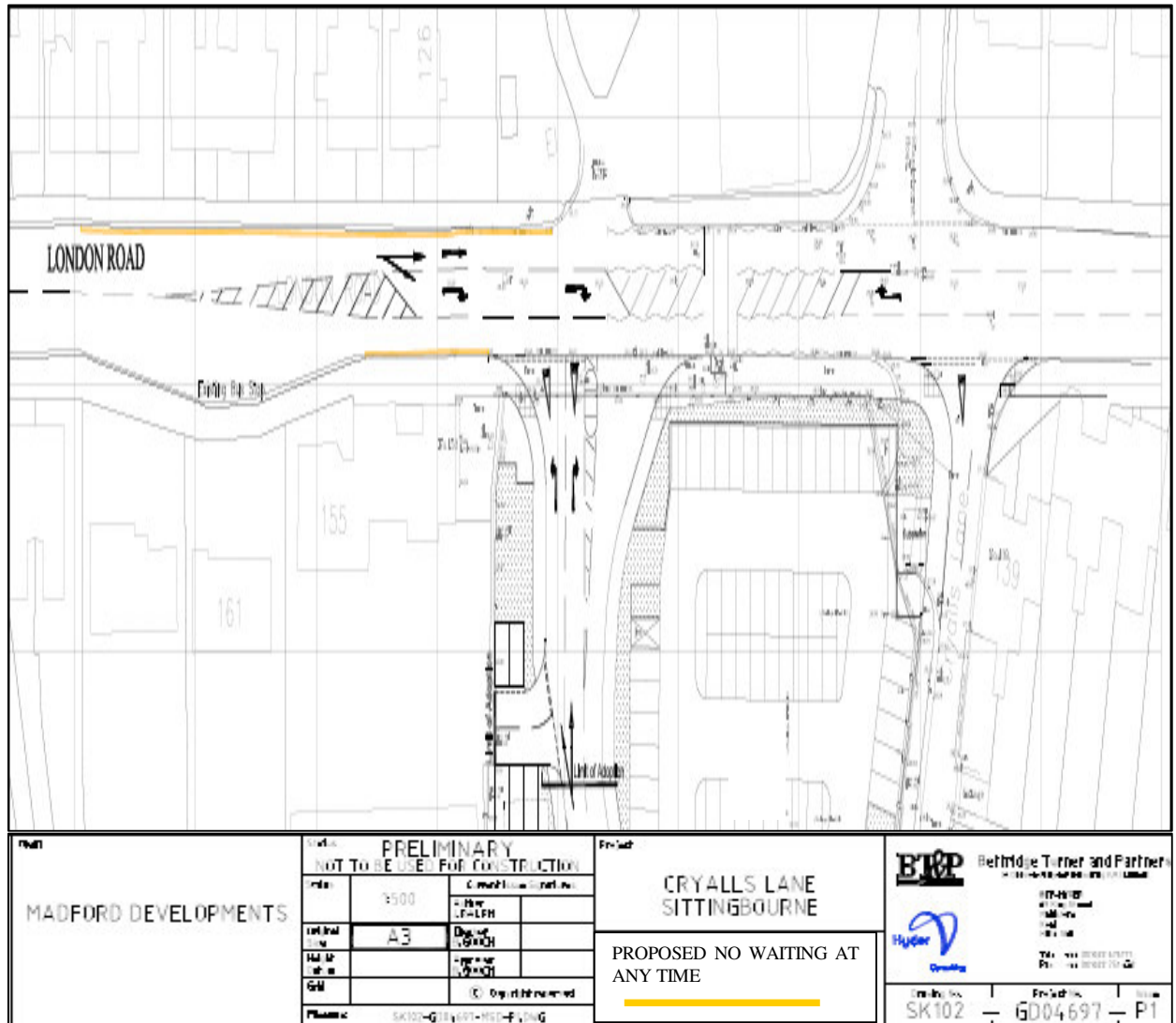

MADFORD DEVELOPMENTS	PRELIMINARY NOT TO BE USED FOR CONSTRUCTION		CRYALLS LANE SITTINGBOURNE PROPOSED NO WAITING AT ANY TIME	E&P Behridge Tither and Partners 11-13 THE SQUARE, STURTON, LEICESTERSHIRE LE12 7JG TEL: 01530 810000 FAX: 01530 810001 WWW.EANDP.CO.UK	
	Scale:	1:500			Consultation Contract No. - None LF=LPH
	Contract No.	A3			Date of Issue - 12/01/01
	Author				Date of Revision - None 12/01/01
GM		© Copyright reserved			
Plan No.	SK102 - G1001 - 101 - F - 100G		Project No. SK102 - G004697 - P1	Issue P1	